

ECLIPSE SMART-HEAT® ELECTRIC



KEY FEATURES

- ▶ **Dual Functionality:** Combines efficient radiant heating with a dimmable LED lighting allowing a seamless transition from afternoon to evening while enhancing ambiance.
- ▶ **Contemporary Design:** Features a modern pendant design with a contemporary matte black finish and radial ceramic screen.
- ▶ **Flexible Mounting Options:** In addition to the complimentary 600mm Twin Pole, the Eclipse Electric can be paired with five other striking pole designs, including wall mounted and ceiling mounted options, to suit various outdoor settings.
- ▶ **Adjustable Heat & Light Settings:** Included controller with wireless remote offers three different heat (33%, 66%, 100%) and incremental light outputs, providing customizable heating performance and ambiance.

DIMENSIONS

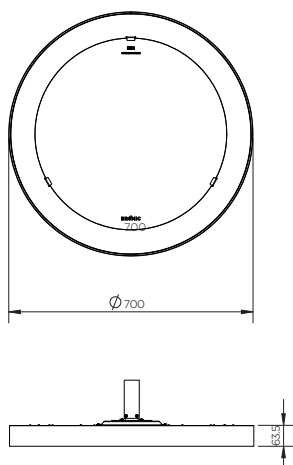

MOUNTING OPTIONS



200mm Straight Pole



600mm Straight Pole



600mm Twin Pole



600mm Curved Pole



1200mm Straight Pole



Wall Pole⁵

BROMIC
HEATING

Learn more at bromic.com

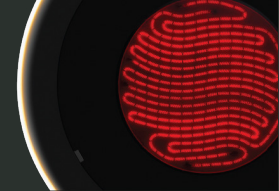

SPECIFICATIONS

PRODUCT NUMBER	WATTAGE	HEAT AREA	WEIGHT	RATED CURRENT	MINIMUM FLOOR CLEARANCE	APPROVAL CERTIFICATION	IP RATING	LED LUMENS	CONTROL OPTIONS
BH0920011-1	3000W	11m ²	14kgs.	220-240V/12.1A	WALL 2348mm CEILING 4348mm	CE-SGS GZES2203005036HS	IP54	497Lm	Affinity Eclipse

CLEARANCES

INCLUDED MOUNT

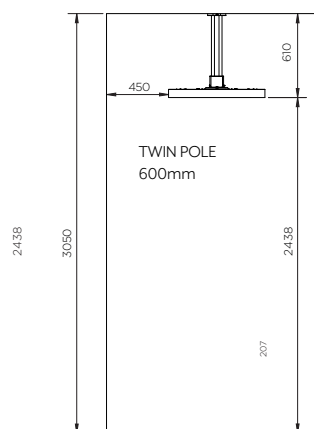

MOUNTING ACCESSORIES

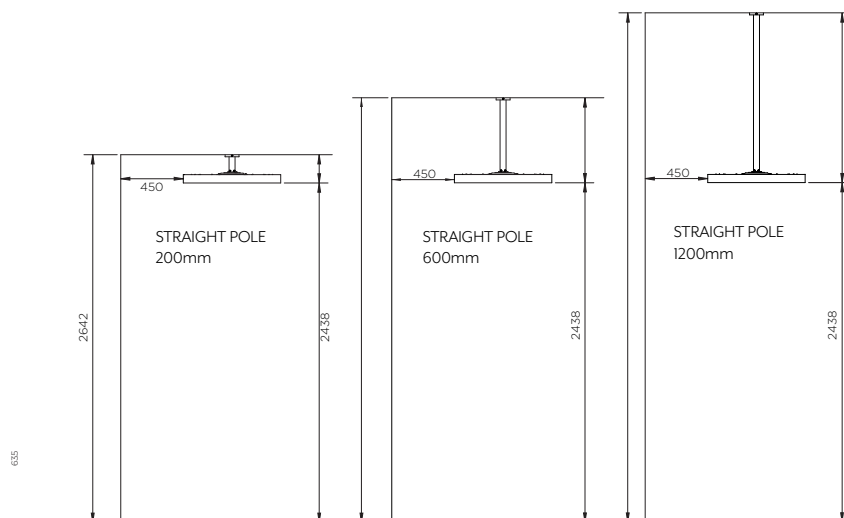

1580

108"
87"

2866

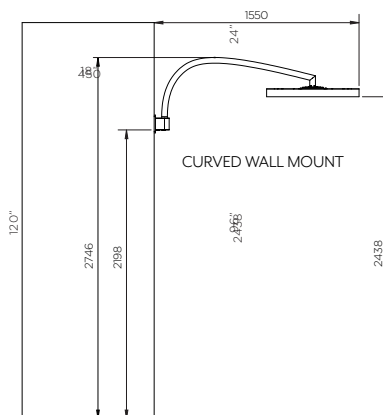
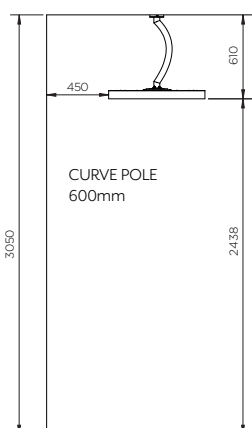

450

610

2438